

REVISIONS			
LTR	DESCRIPTION	DATE	APPROVED
A	Delete "part number" and substitute "Part or Identifying Number (PIN)". Vendor CAGE 60563, PIN's, delete and substitute new PIN's. Editorial changes throughout.	01-01-22	Robert M. Heber
B	Add Vendor CAGE SW884, delete MIL-STD-1344 test methods, add EIA-364 test procedures	06-01-20	Richard L. Taylor

Prepared in accordance with ASME-Y14.100

REV																			
PAGE																			
REV STATUS OF PAGES	REV	B	A	B	B														
	PAGE	1	2	3	4														
PMIC N/A	PREPARED BY Ralph Antonelli				DEFENSE SUPPLY CENTER, COLUMBUS COLUMBUS, OHIO 43218-3990														
Original date of drawing 31 July 1990	CHECKED BY Carl Dello-Stritto				TITLE CONNECTOR, ELECTRICAL, INSERT ARRANGEMENT, MINIATURE, THREE SIZE 8 CONTACT CAVITIES														
	APPROVED BY Charles W. Koeller																		
	SIZE A	CAGE CODE 037Z3				DWG. NO.				89075									
	REV B				PAGE 1				OF 4										

Engaging face (pin)

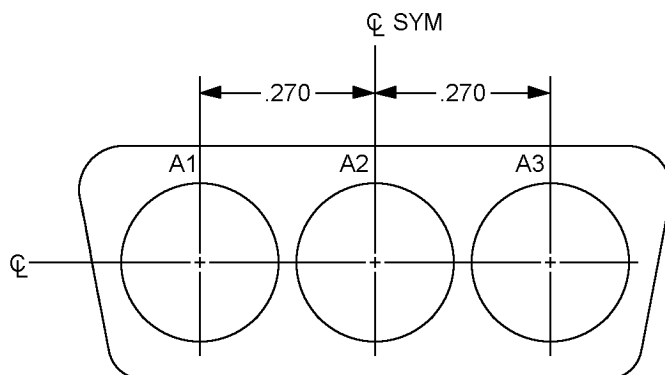

Inches	mm
.270	6.86

NOTES:

1. Dimensions are in inches.
2. Metric equivalents are given for information only.
3. Unless otherwise specified, tolerance for three place decimals is ± 0.005 inch (0.13 mm).
4. All dimensions are true position (TP).
5. Contact holes in insert shall be located on TP within a .005 inch (0.13 mm) diameter circle.
6. Markings are shown for the pin insert front. Socket inserts are the opposite.
7. Reference documents shall be of the issue in effect on date of invitations for bid.

FIGURE 1. Insert arrangement, three size 8 contact cavities.

DEFENSE SUPPLY CENTER, COLUMBUS COLUMBUS, OH 43218-3990	SIZE A	CAGE CODE 037Z3	DWG NO. 89075
		REV A	PAGE 2

ENGINEERING DATA:

Voltage rating: 500 volts rms at sea level.

Operating temperature: -55°C to +125°C.

REQUIREMENTS: Requirements of drawing 85039 and MIL-DTL-24308 are applicable.

Dimensions and configurations: See figure 1.

Shell size: Two.

Shell specifications:

Socket: MIL-DTL-24308/1, figure 1.

Pin: MIL-DTL-24308/3, figure 1.

Dielectric withstanding voltages: See table I.

TABLE I. Dielectric withstanding voltages.

Altitude	Humidity condition	All other conditions
Sea level	600	1,000
70,000	---	325

Vibration: Test procedure EIA364-28, test condition IV.

Temperature cycling: Test procedure EIA364-32, condition 1, 5 cycles, except temperature shall be -55°C to +125°C.

DEFENSE SUPPLY CENTER, COLUMBUS
COLUMBUS, OH 43218-3990

SIZE
A

CAGE CODE

037Z3

REV

B

DWG NO.

89075

PAGE

3

Approved sources of supply are listed herein. Additional sources will be added as they become available. The vendors listed on the requirements drawing have agreed to this drawing and a certificate of compliance has been submitted to DSCC-VAI.

DSCC drawing PIN <u>2/</u> <u>3/</u> <u>4/</u> <u>5/</u>	Vendor similar PIN <u>1/</u>			
	CAGE 71468	CAGE 60563	CAGE 28198	CAGE SW884
89075GULPT 89075GULST 89075GULPR 89075GULSR	DAMMY3W3PA101 DAMMY3W3SA101 DAMM3W3PA101 DAMM3W3SA101	P33P2D P33R2D P33P2 P33R2	CBM3W3M02F00C-0 CBM3W3F02F00C-0 CBM3W3M02000C-0 CBM3W3F02000C-0	PCMMHW3W3P PCMMHW3W3S PCMMW3W3P PCMMW3W3S

- 1/ Caution. Do not use this number for item acquisition. Items acquired to this number may not satisfy the performance requirements of this drawing.
- 2/ Connectors supplied to this drawing shall include a full complement of signal contacts.
- 3/ Size 8 contacts should be ordered separately.
- 4/ Size 8 contacts are snap-in and removable.
- 5/ For size 8 contacts, see DSCC drawings 89046 through 89061.

<u>Vender CAGE number</u>	<u>Vendor name and address</u>
28198	Positronics Industries, Incorporated 423 North Campbell Springfield, MO 65801-8247
60563	The Phoenix Company 555 Pond Drive Wood Dale, IL 60191-1192
71468	ITT Cannon P.O. Box 929 666 East Dyer Road Santa Ana, CA 92702-0929
SW884	The Phoenix Company of Chicago, Mexico Carretera Internacional K M 1969 Guadalajara Nogales KM 2 Empalme, Mexico 85340

DEFENSE SUPPLY CENTER, COLUMBUS COLUMBUS, OH 43218-3990	SIZE	CAGE CODE	DWG NO.
	A	037Z3	89075
		REV B	PAGE 4